

MIT OpenCourseWare
<http://ocw.mit.edu>

11.307 Beijing Urban Design Studio
Summer 2008

For information about citing these materials or our Terms of Use, visit: <http://ocw.mit.edu/terms>.

flexible moduling in an environmental framework

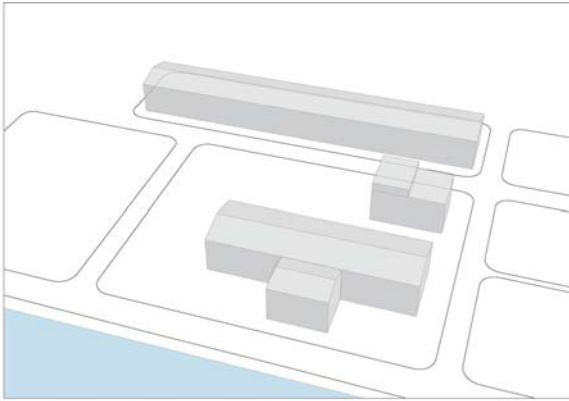

Large existing buildings with adaptable interior space are reserved to first house soil remediation and related industries

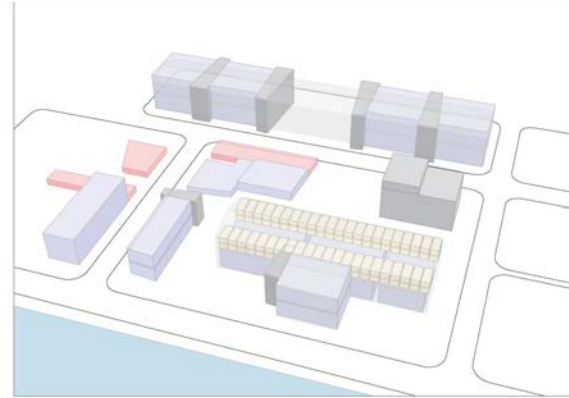

As soil remediation moves out of the major spaces, other industrial uses as well as migrant housing will move in provisionally as the rest of the site is developed into industrial and light commercial enterprises

Industrial spaces become commercial and housing

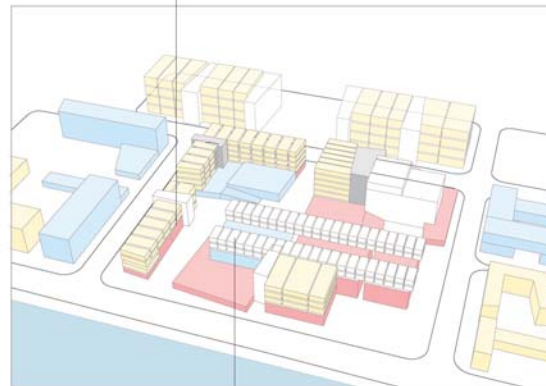

As the remediation activities move elsewhere on the Shougang site, the remaining industrial volume can be broken up into smaller commercial and residential spaces while larger spaces will become civic and entertainment venues.

As migrants move to other parts of the site, their housing becomes middle class apartments

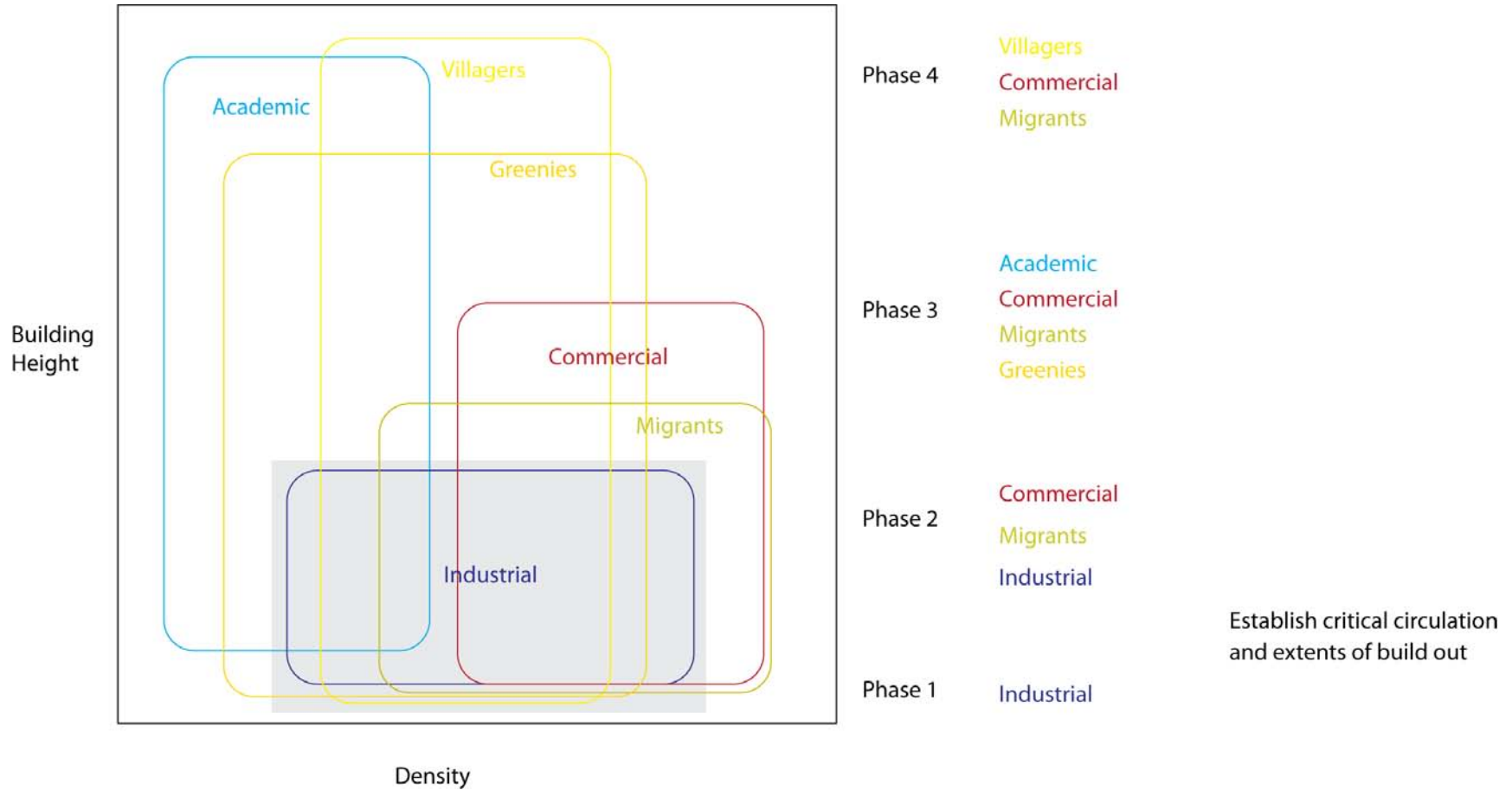

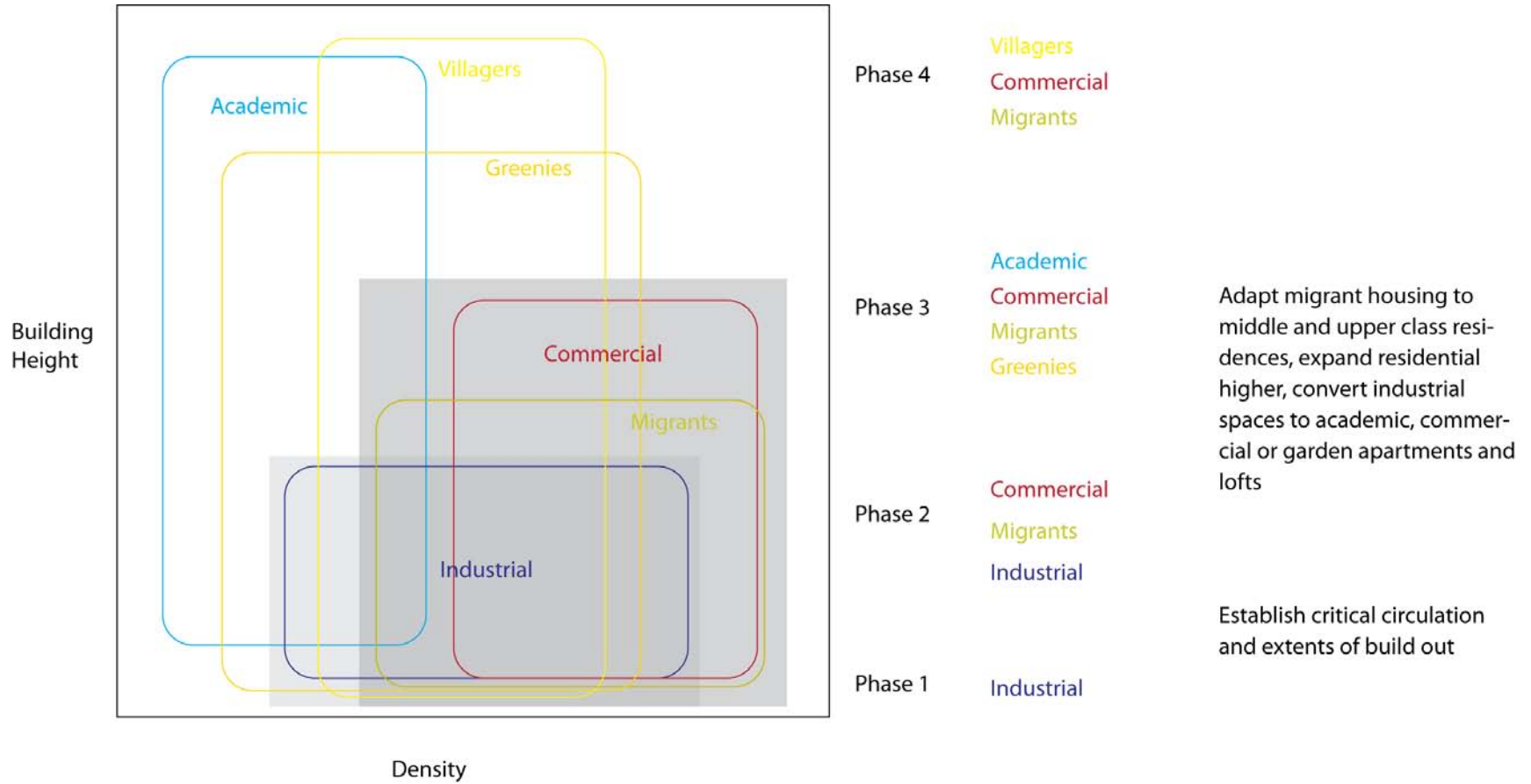

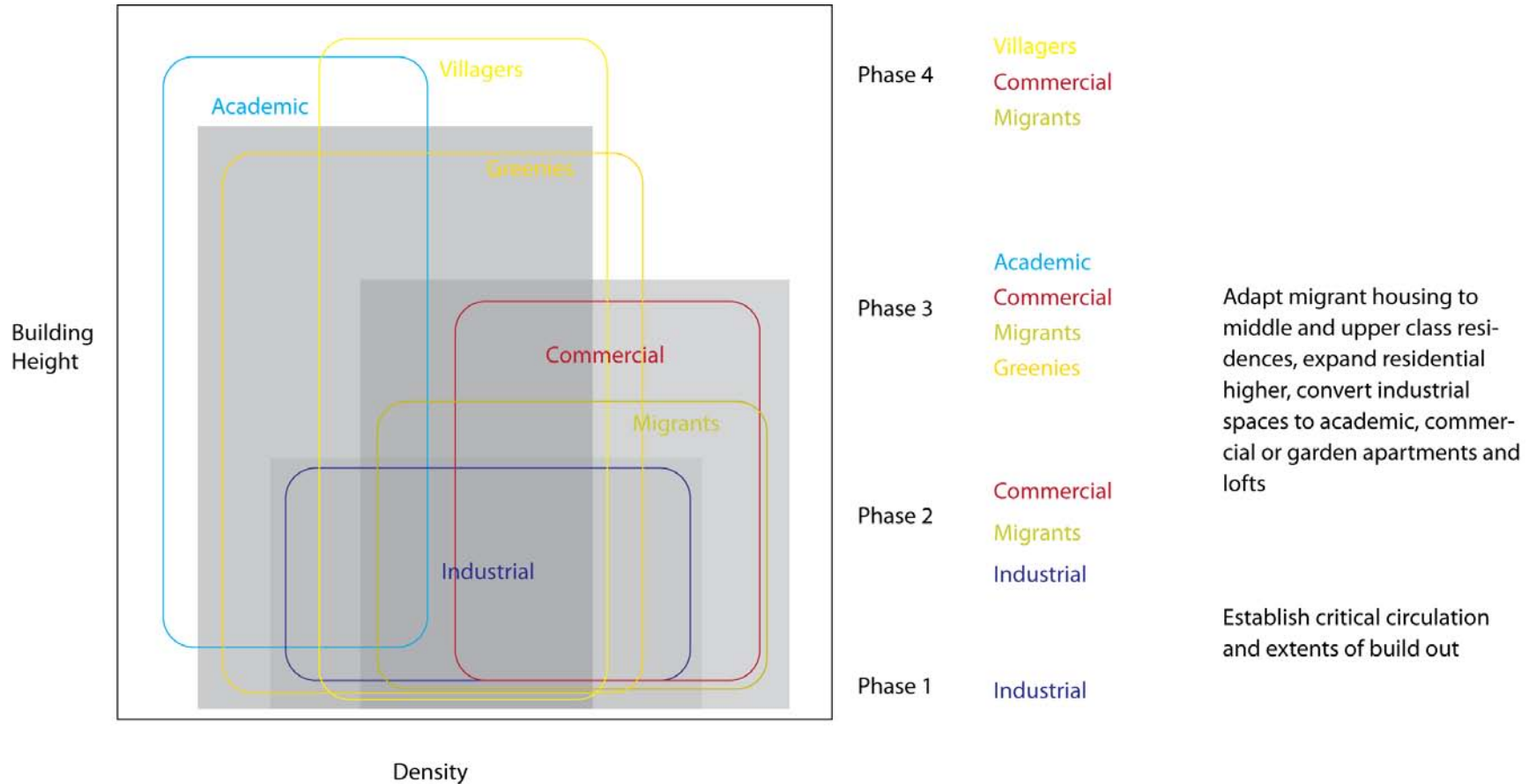

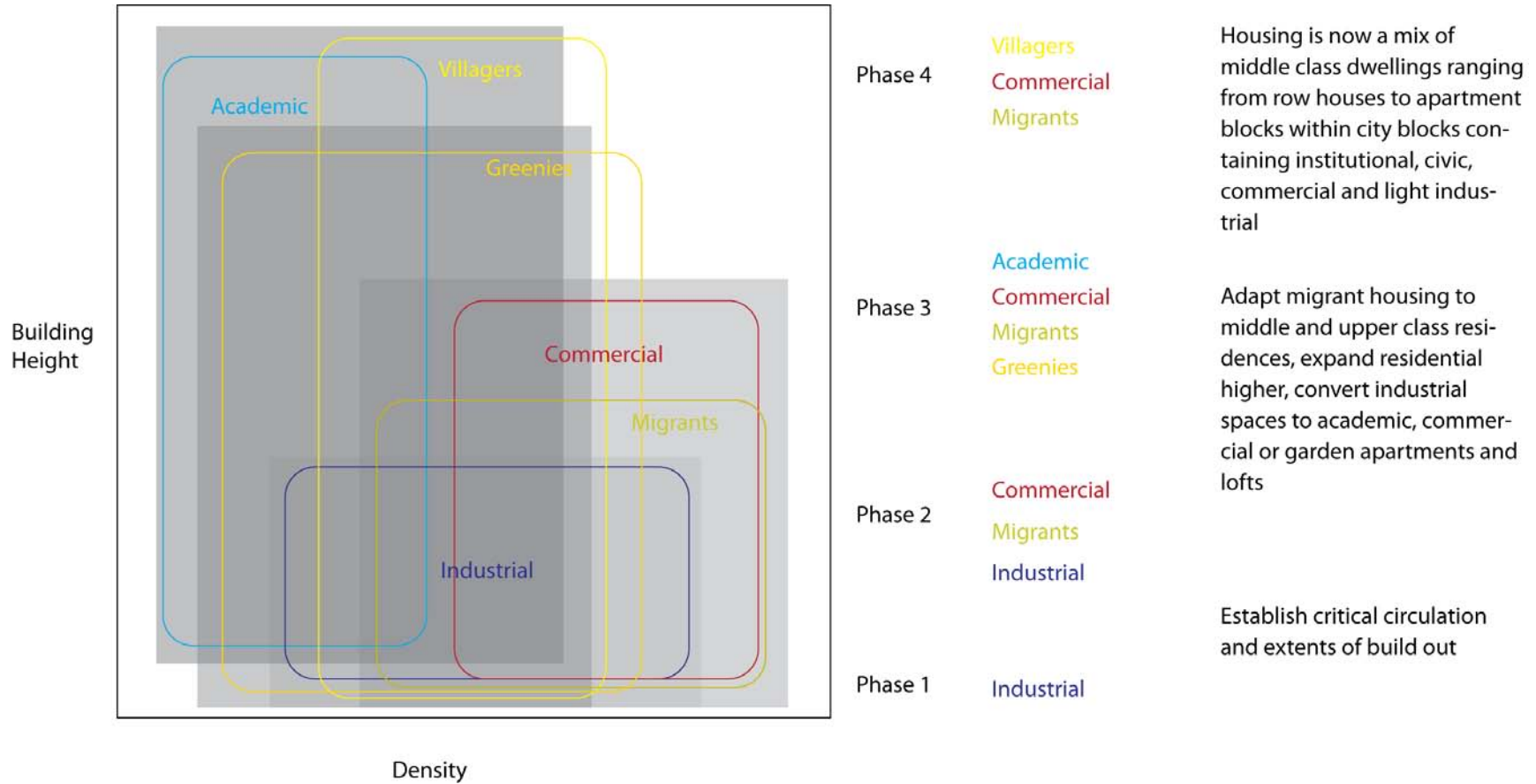

prototypical development north of the little hot lake



long narrow strip

keith case - zhang ruoxi - ma xiaoying - kristina katich - marissa grace desmond

prototypical development north of the little hot lake



long narrow strip

keith case - zhang ruoxi - ma xiaoying - kristina katich - marissa grace desmond

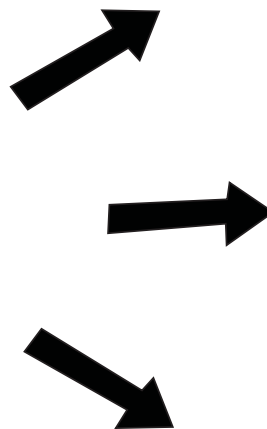
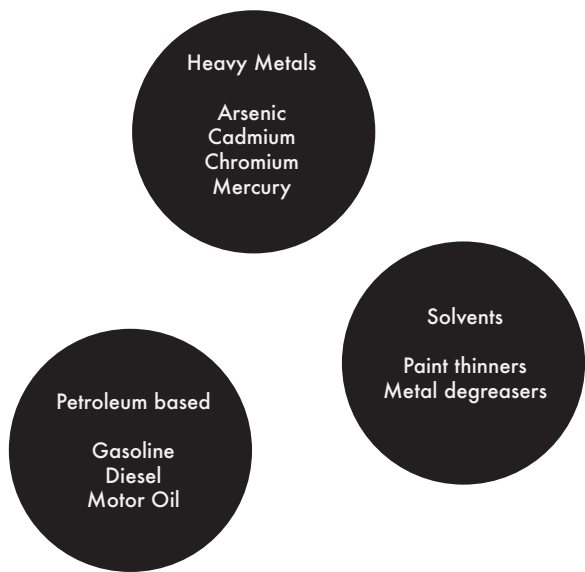
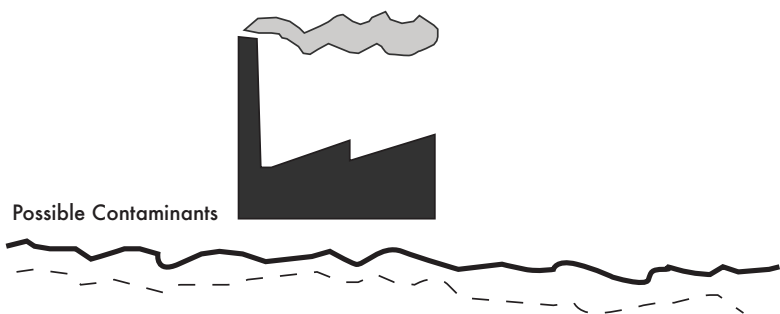

Methods of cleaning

- Excavation and landfill
- Capping
- Solification
- Soil flushing
- Soil washing
- Vitrification
- Soil incineration
- Thermal desorption
- Bioremediation
- Phytoremediation

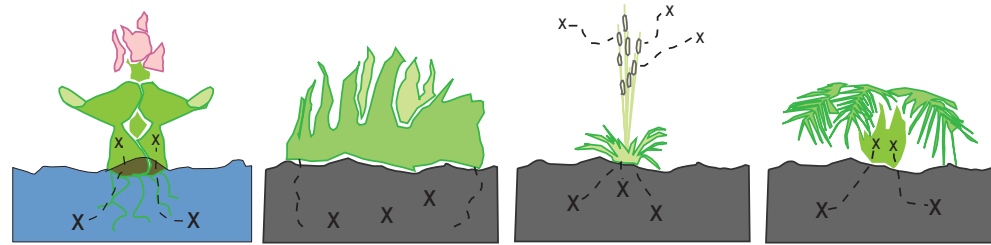

	Rhizofiltration	Phytostabilization	Phytovolatilization	Phytoextraction
Mechanics	Hydroponically raised plants placed in contaminated water concentrate the metals in their roots and shoots	Contaminant migration via wind, rain, and groundwater prevented through planting	Plants absorb elemental metals from the soil and biologically convert them to gaseous metals and release them into the atmosphere	Roots absorb contaminants and store them in above ground shoots
Pros	Cost effective for large volumes; applicability to many metals; less need for chemicals; reduced volume of secondary waste; possibility of recycling; appealing to regulators and public	Less expensive; less invasive; easy to implement; aesthetic value; allows for the postponement of action	Minimal site disturbance; less erosion; no need to dispose of contaminated plants; require little maintenance	Cost effective for large areas; reduce in contaminant mass; metals may be extracted from plant material; metal enriched plants may be sold
Cons	Small, slow growing root systems; the need to specialized facilities and expertise	Not appropriate for highly contaminated sites; does not remove pollution; requires soil additives	Less control over path of contaminants; may contaminate air	Slow process; cannot reach deep contamination; must dispose of plants
Affected Contaminants	Chromium, lead, zinc, petroleum hydrocarbons, chlorinated solvents, benzene, ethylbenzene, xylenes	Lead, zinc, copper, selenium, trichloroethylene, mercury, arsenic	Arsenic, Mercury, Selenium	Variety of solvents, Zinc, nickel, cadmium, lead, titanium, chromium
Plants	Water hyacinth, duckweed, pennywort	Grasses	Cattails, tobacco	Sunflower, indian mustard, Chinese brake fern
Alternative	Rhizodegradation			Phytodegradation

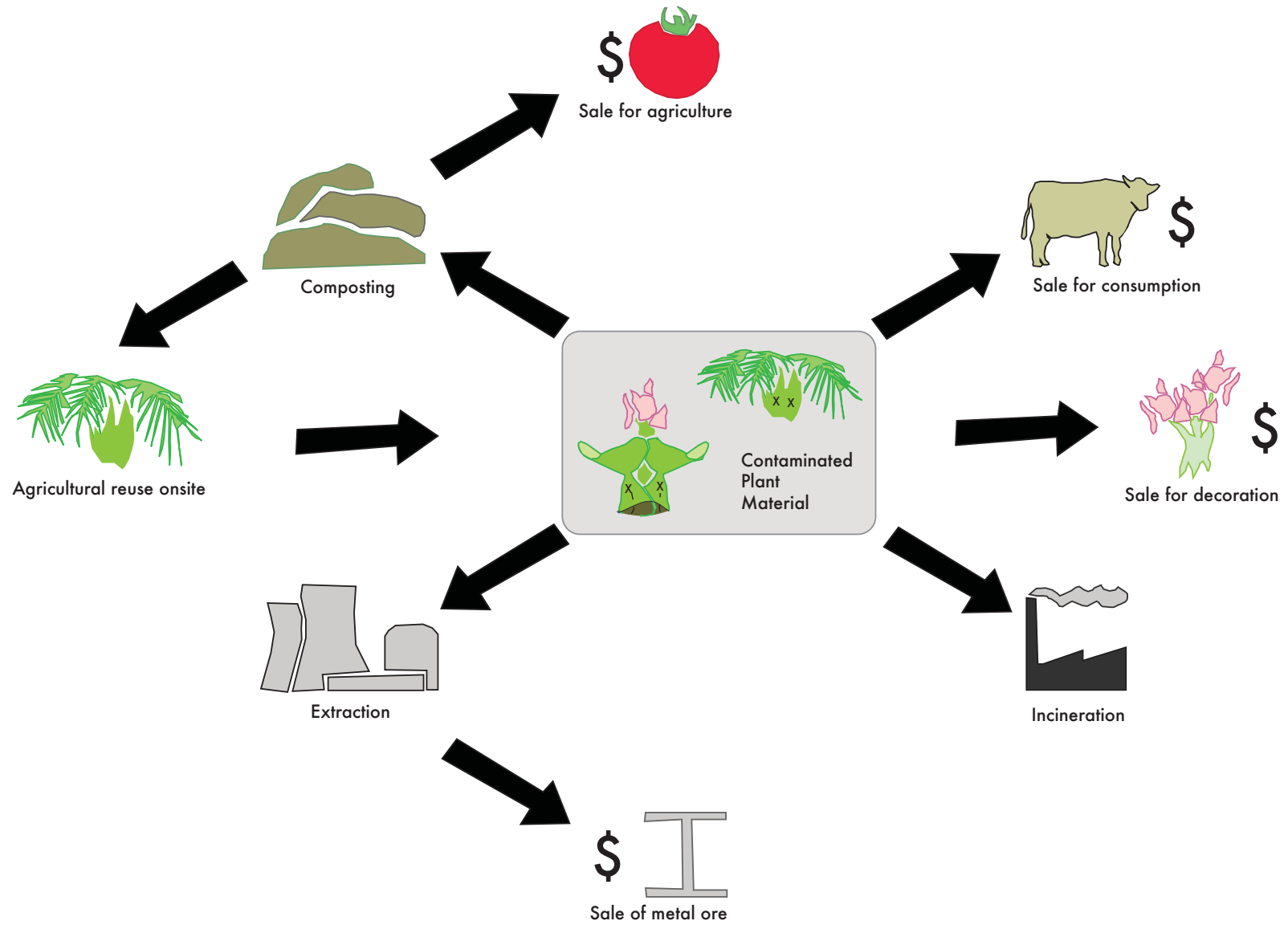

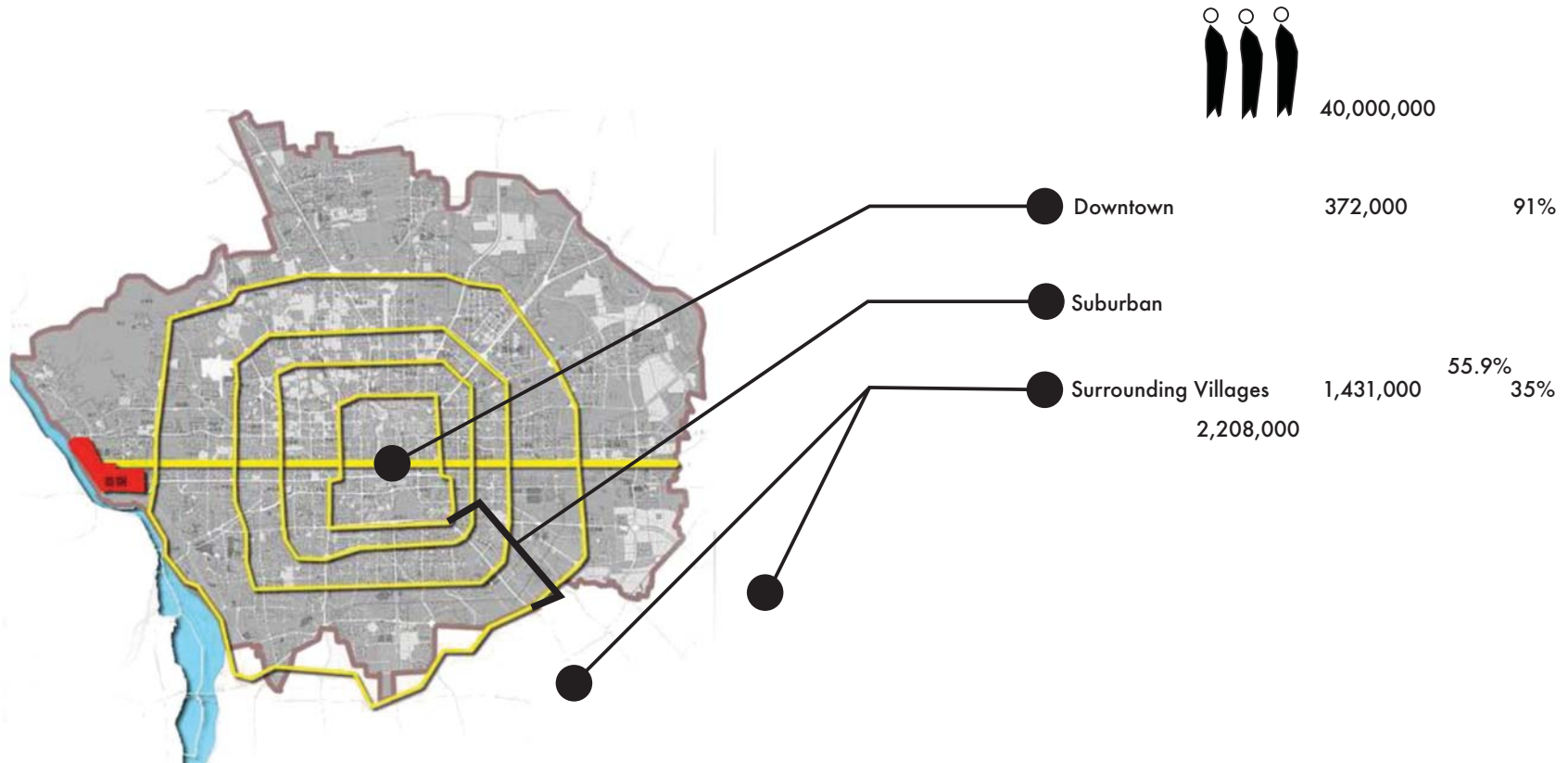

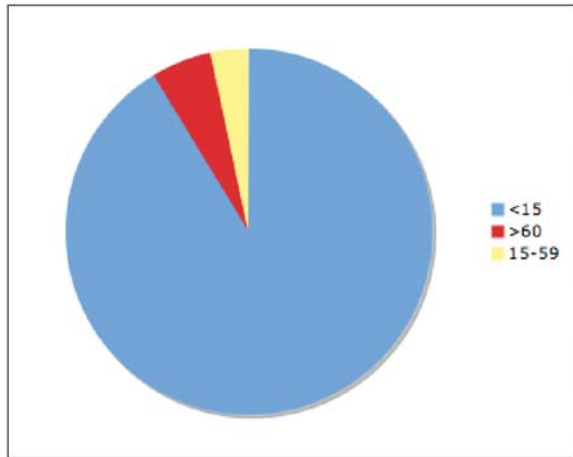

Implications:
Facility needs change as individuals form families

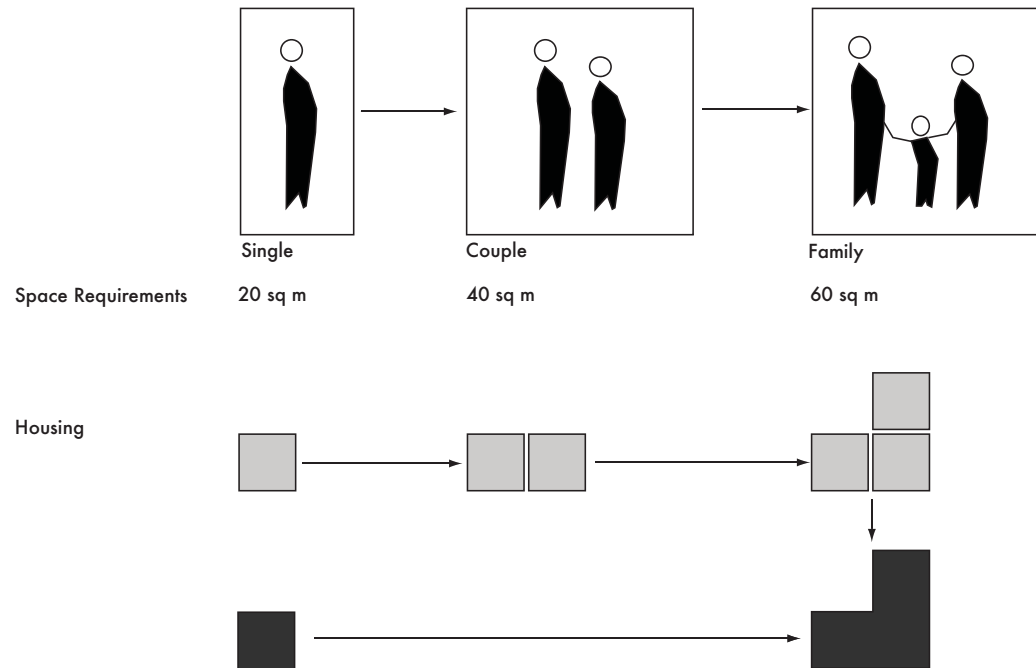

Family unit

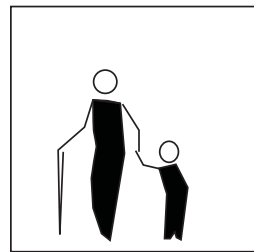

Shougang family

Age ranges:
Under 15
50-80

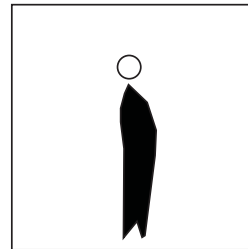

Migrant

Age range:
15-39

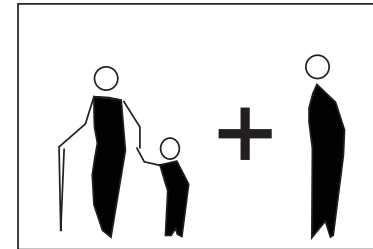

New "family" group provides mutual support

Shougang family provides migrants with low rent
Migrant provides family with labor
Both provide emotional support

Distribution

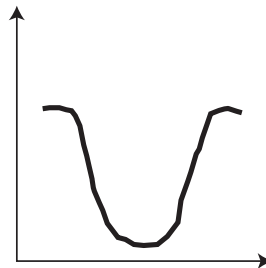

Shougang family

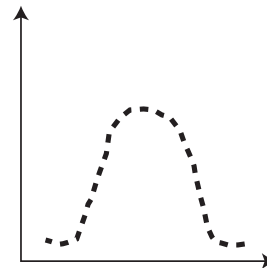

Migrant

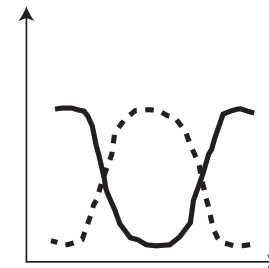

New family group





In 2005 the Chinese government proposed building 5 ecocities.

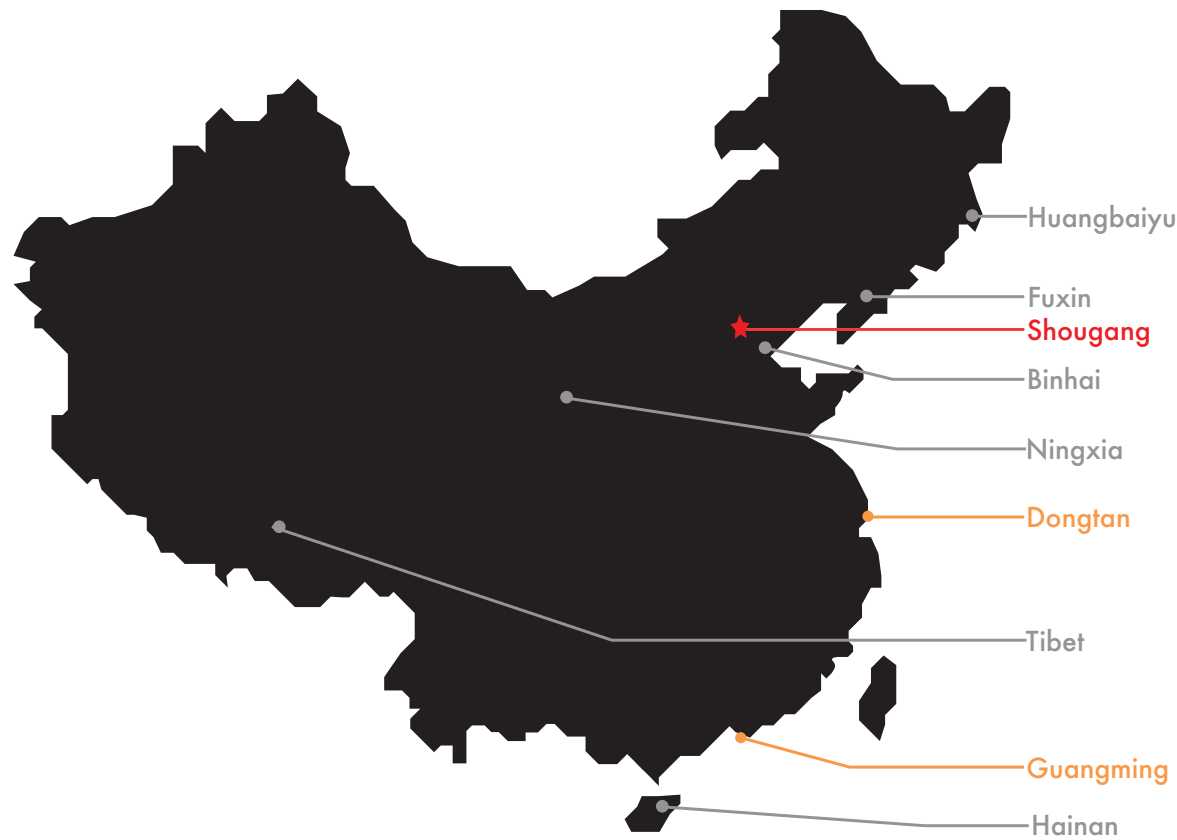

Dongtan

Self sustaining community near Shanghai
500,000 people by 2030
Criticized as an elite community focused towards ecological commuters

Guangming

Self sustaining community near Shenzhen
7.92 sq km area
Farmland incorporated in landscape and buildings

- Communities with wind or solar initiatives
- Chinese government sponsored ecocities
- ★ Proposed socially conscious ecocity

everyone can remediate their share
environmentally conscious living on any scale
one soil, one dream

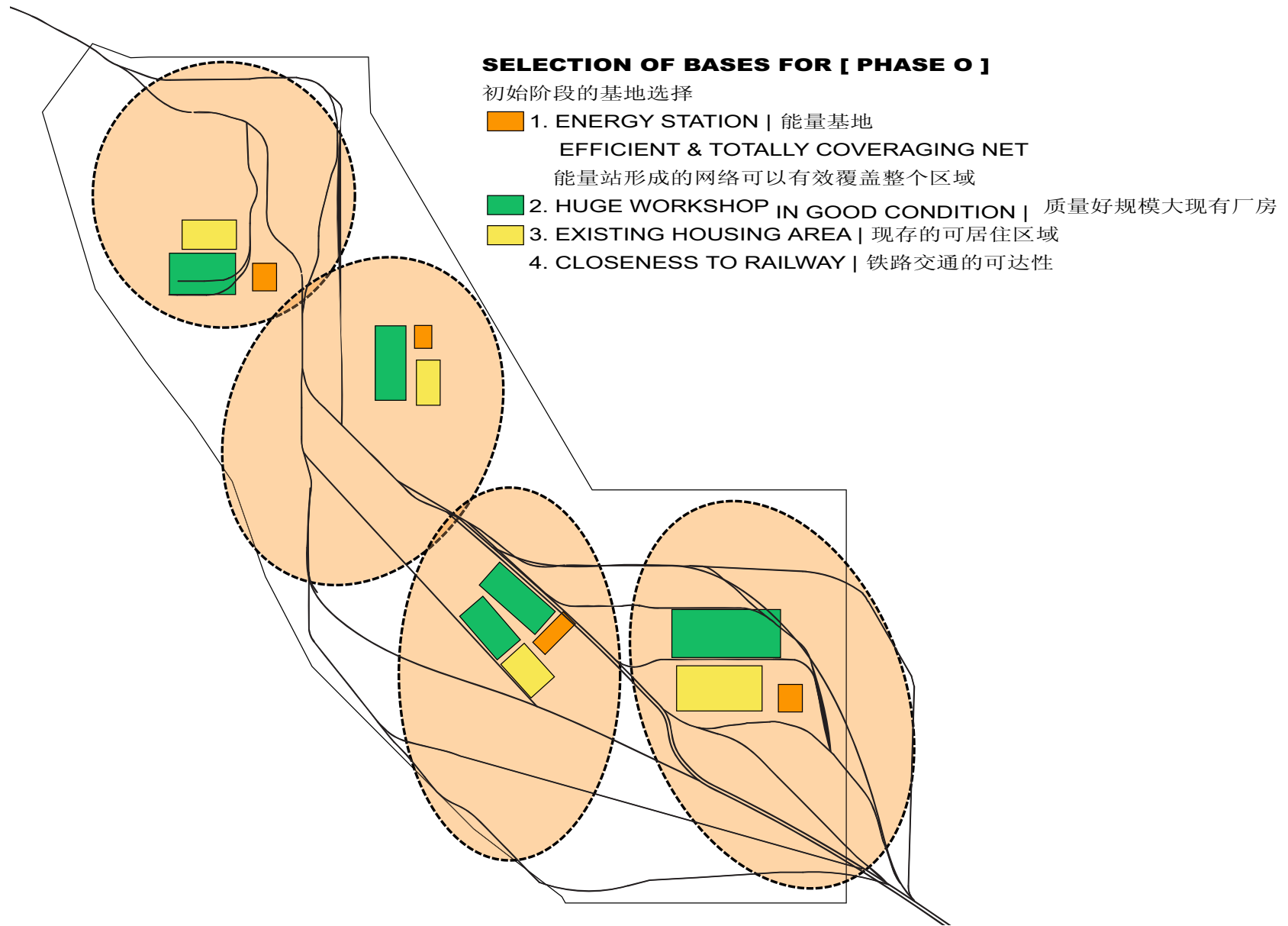



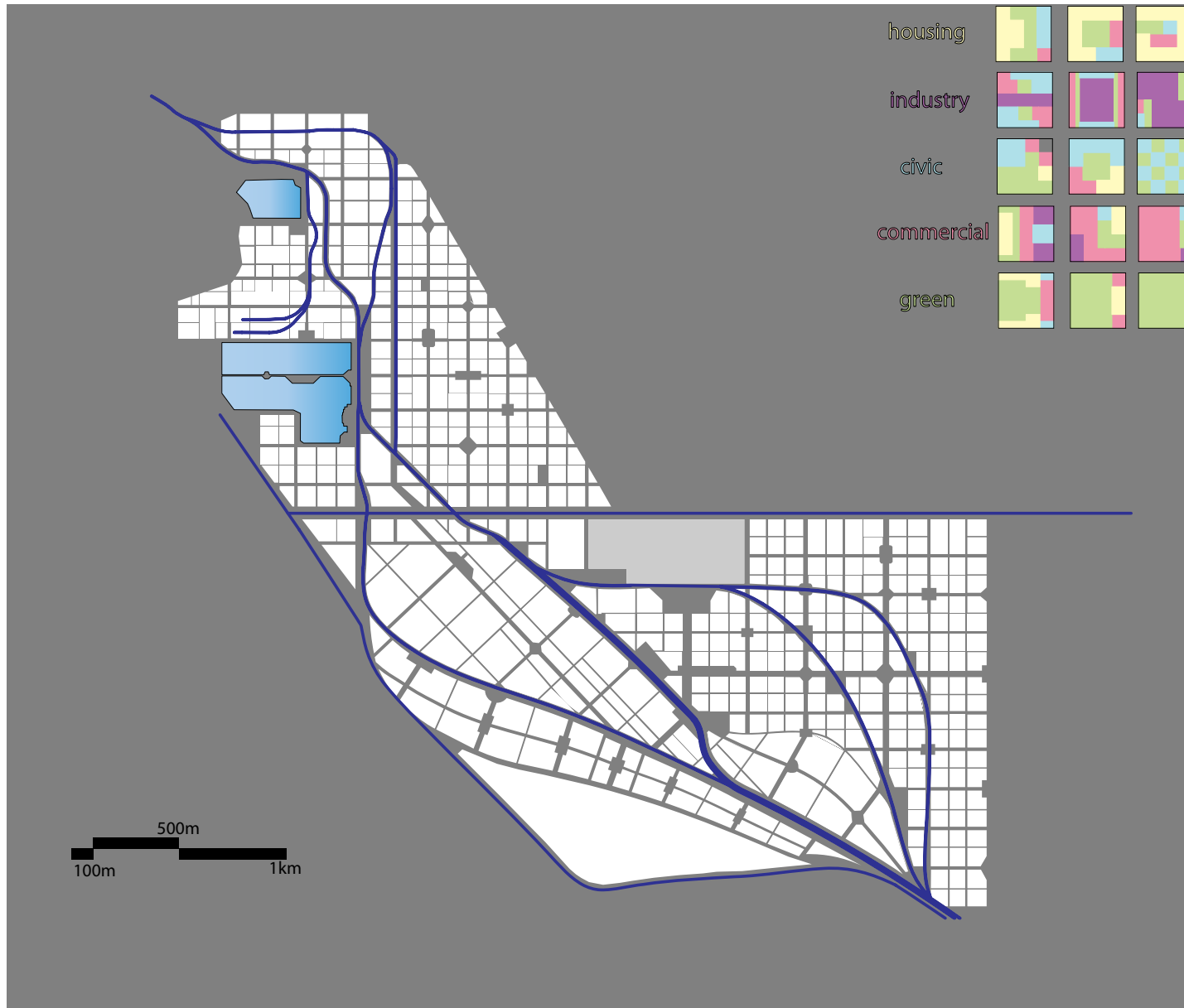

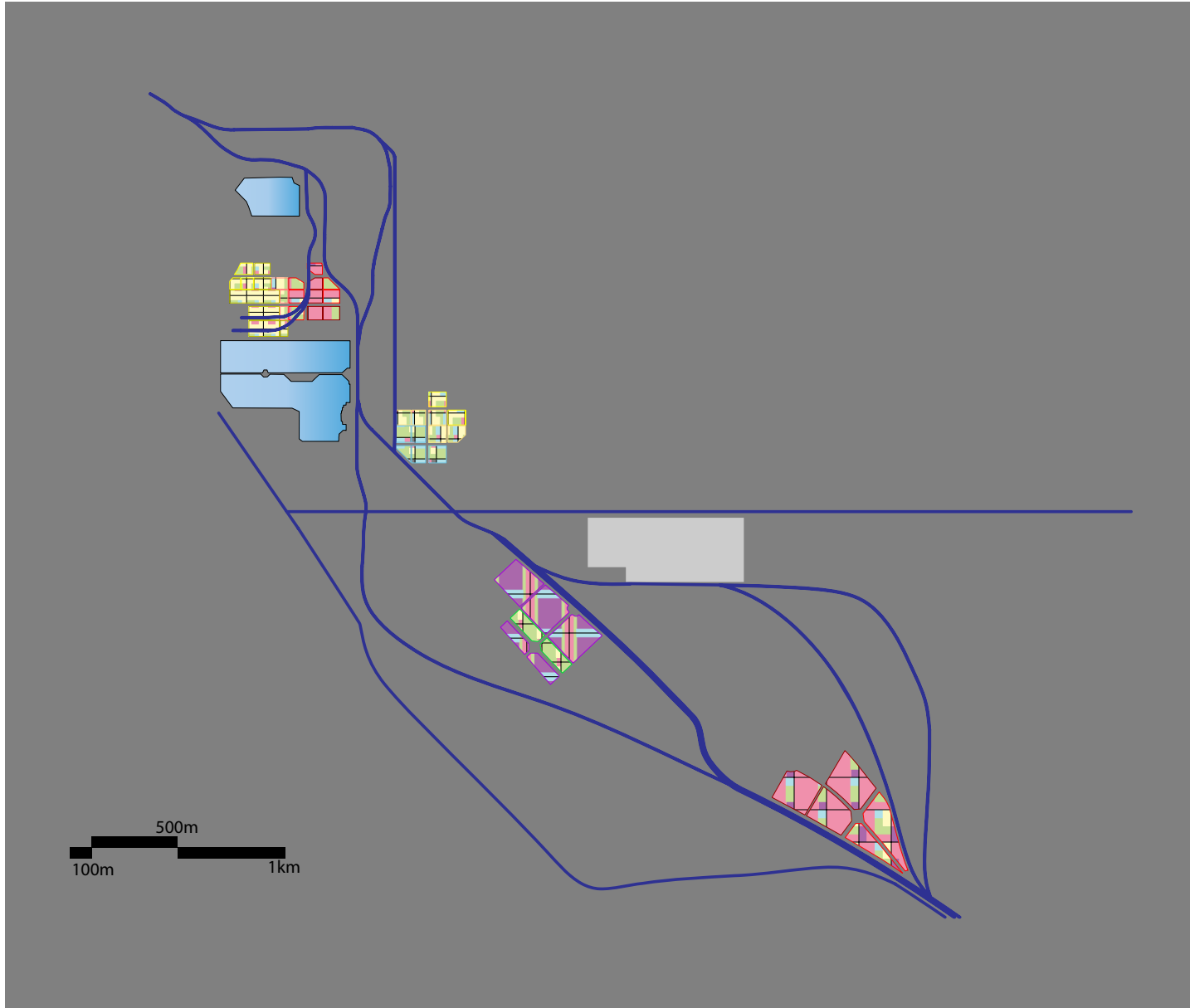

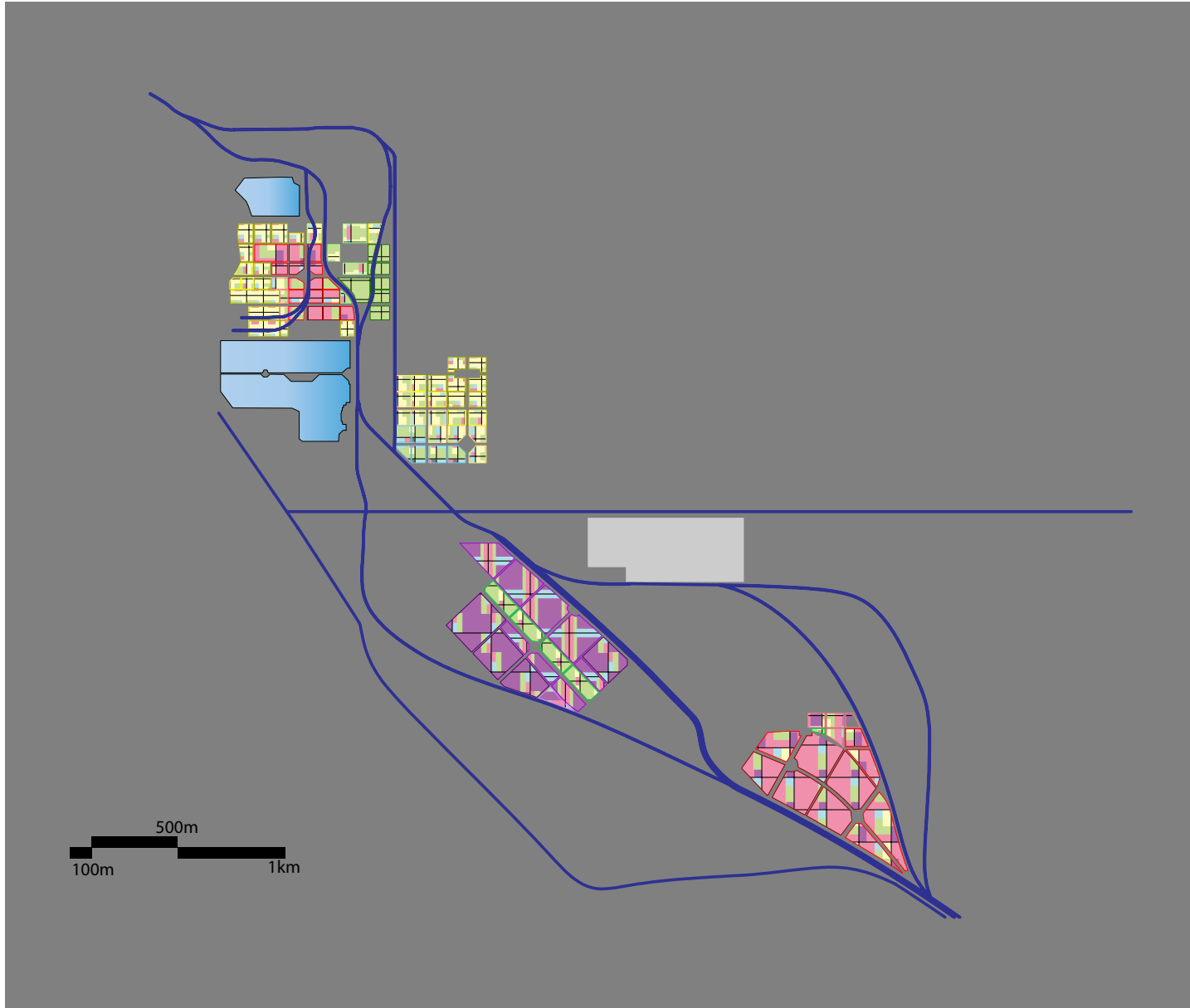

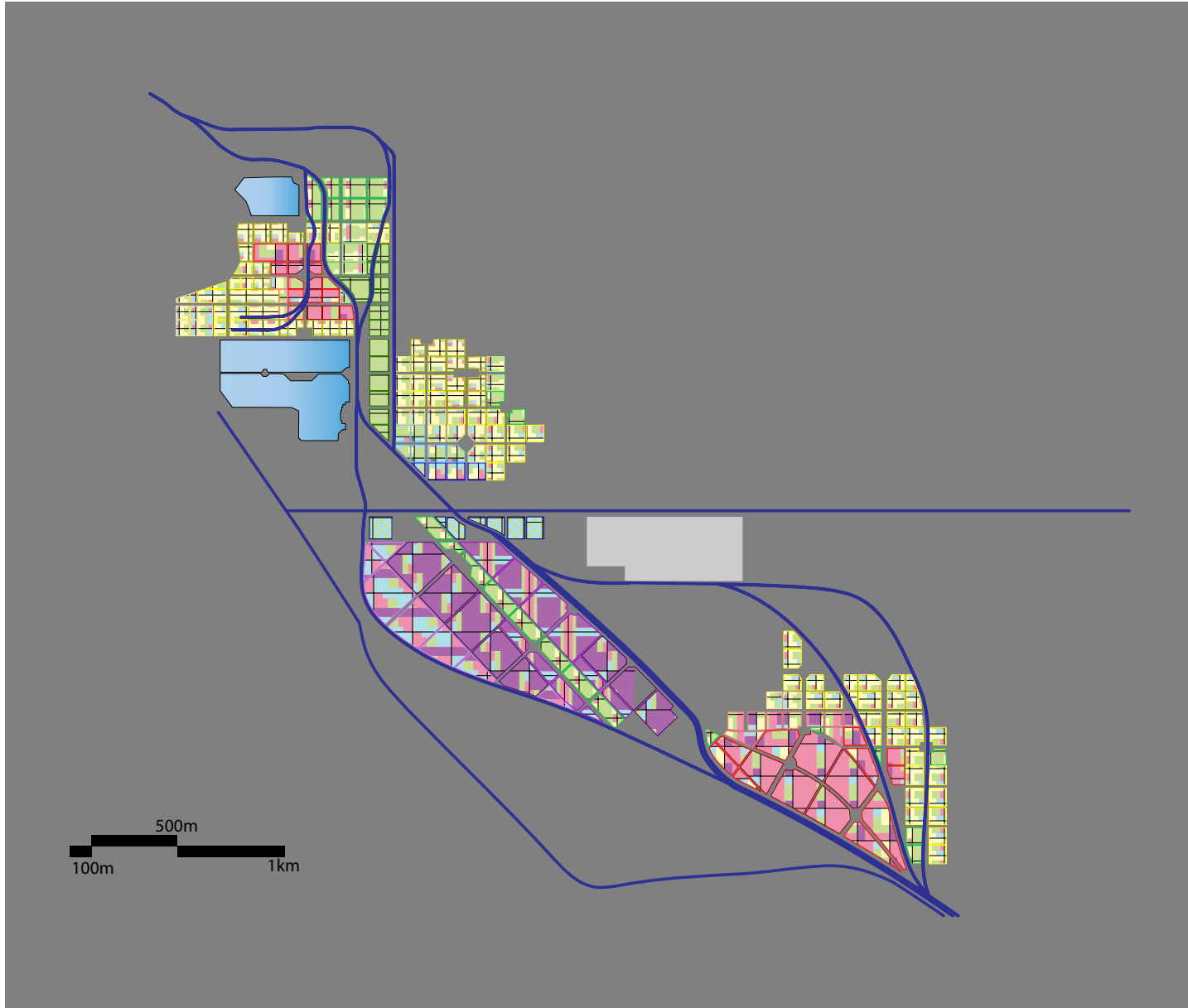

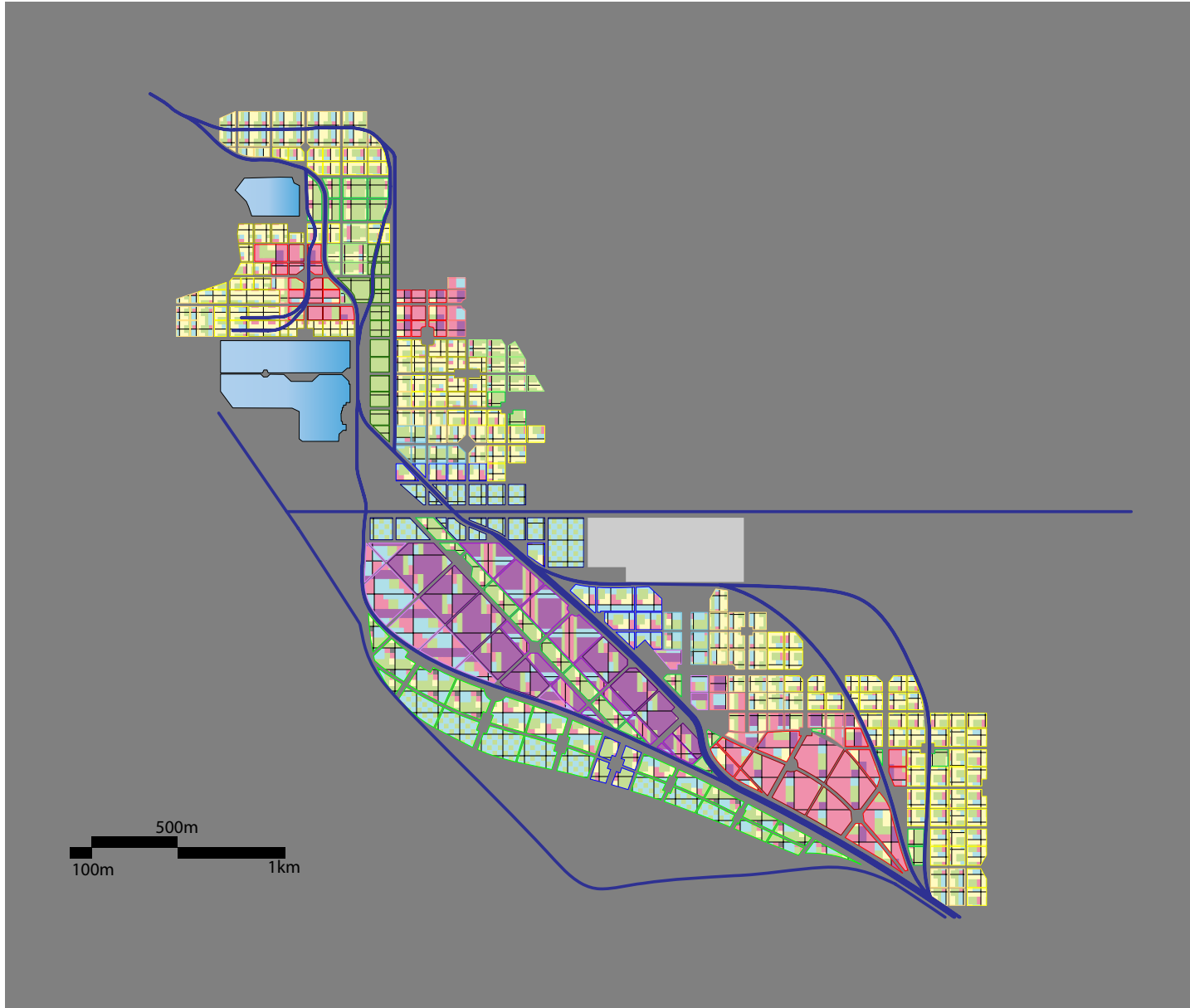

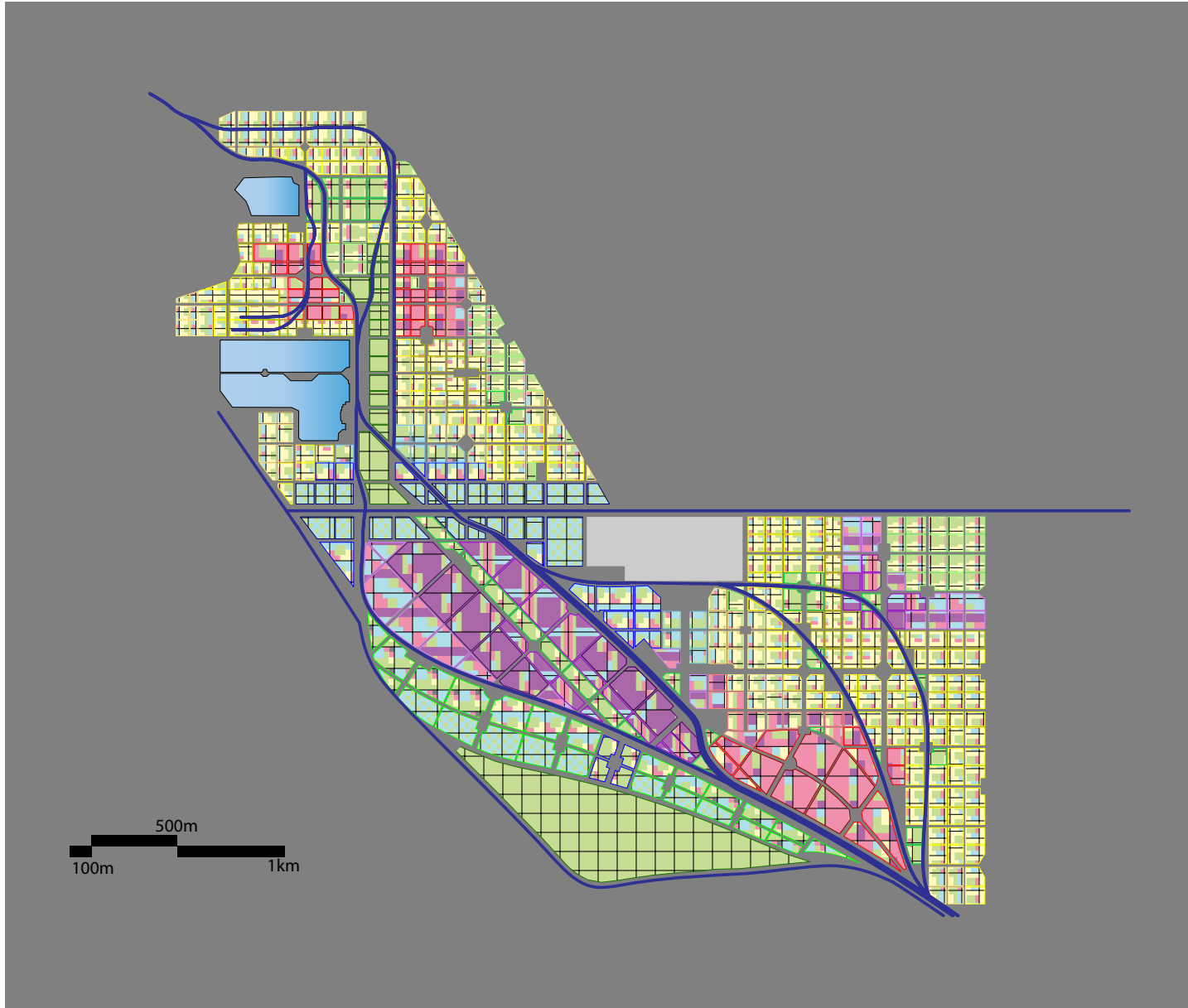

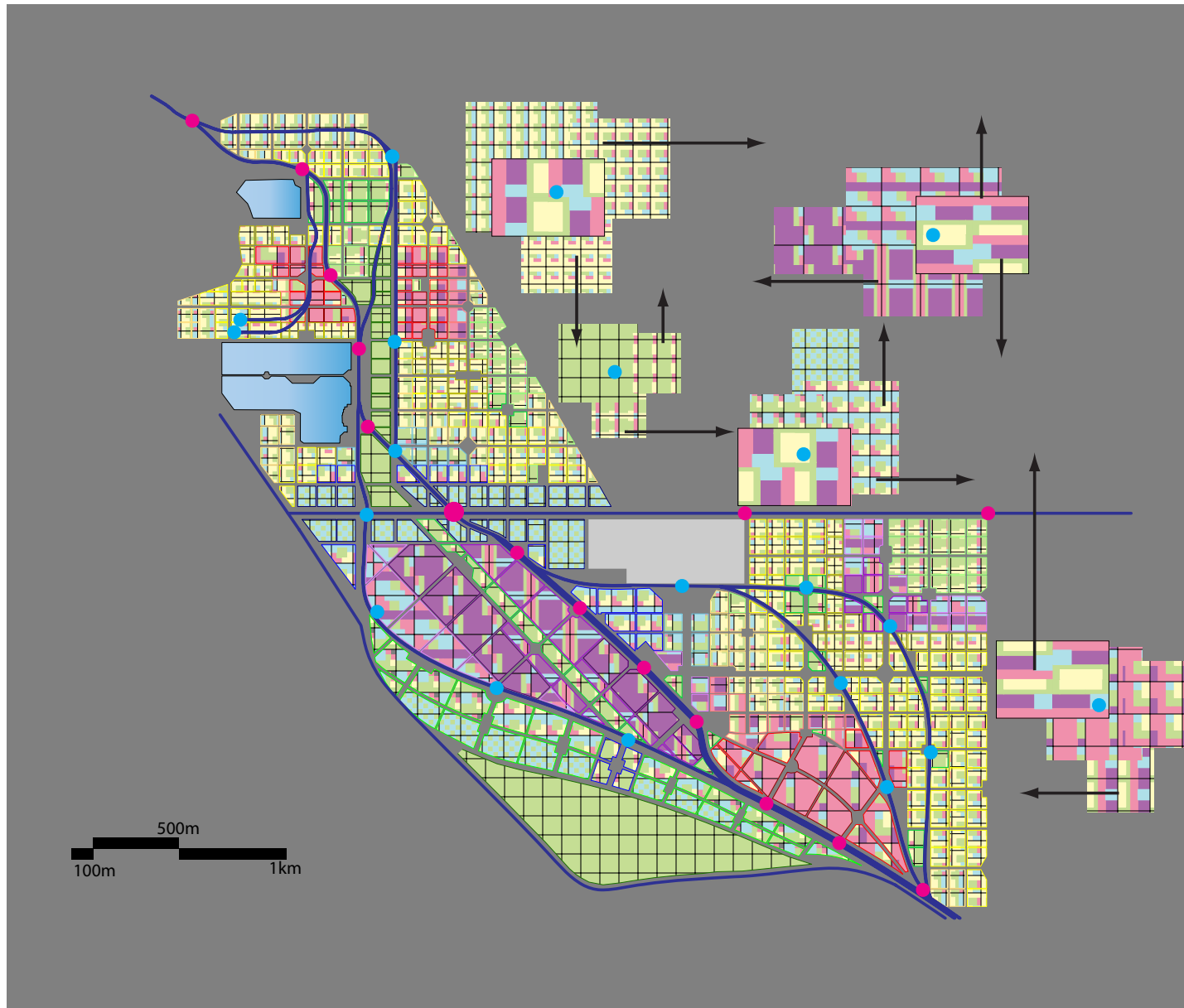

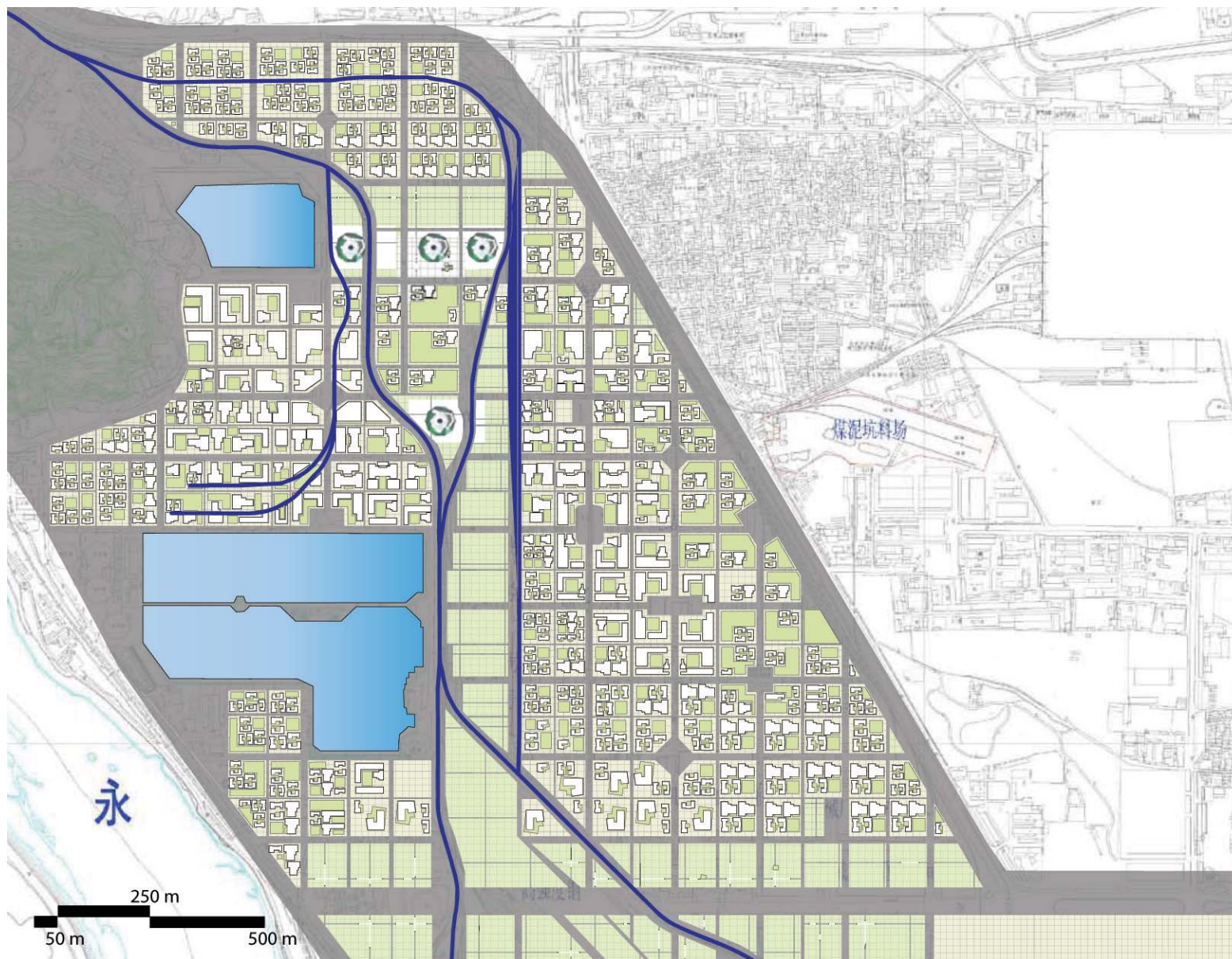

long narrow strip

keith case - zhang ruoxi - ma xiaoying - kristina katic - marissa grace desmond

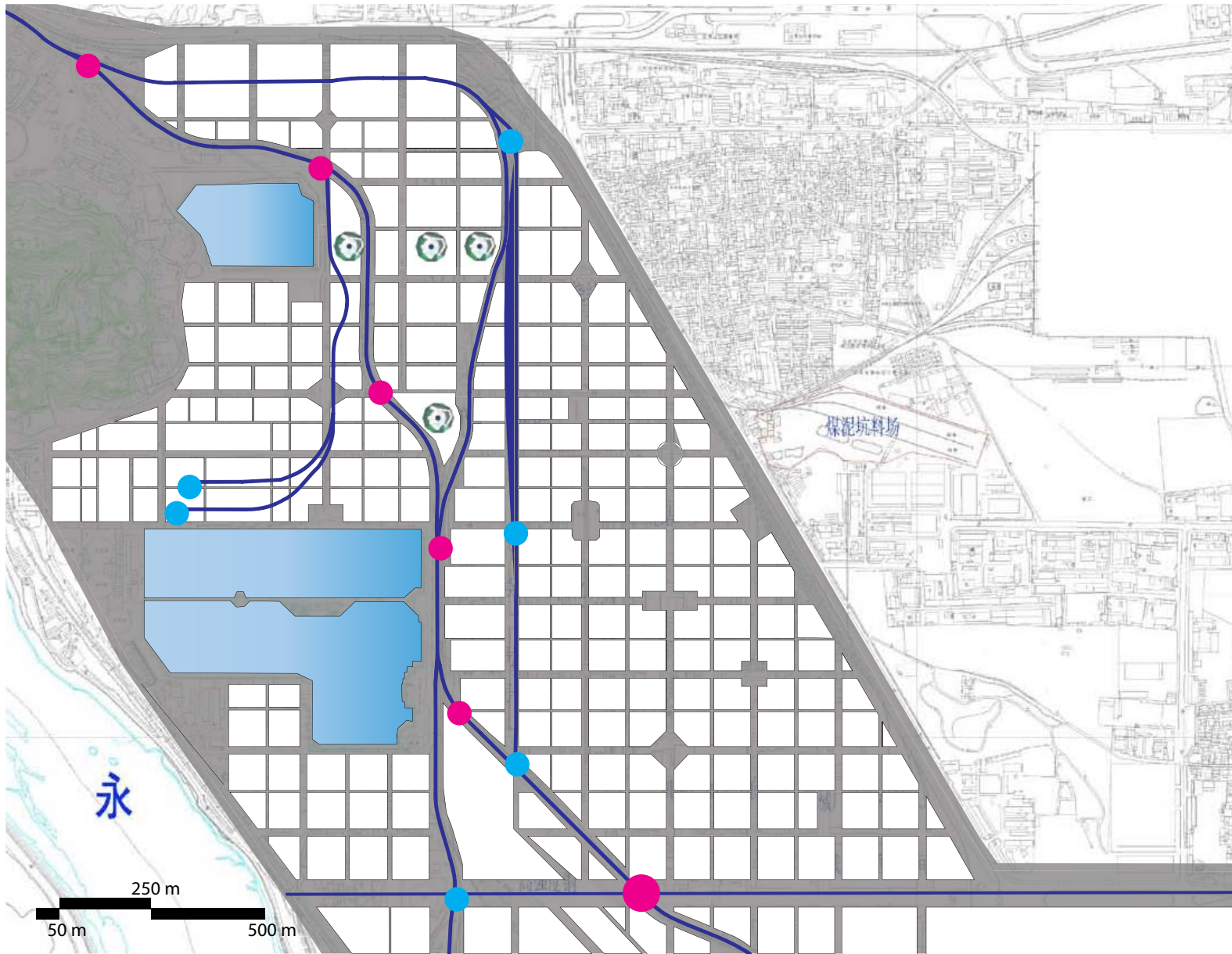

long narrow strip

keith case - zhang ruoxi - ma xiaoying - kristina katich - marissa grace desmond

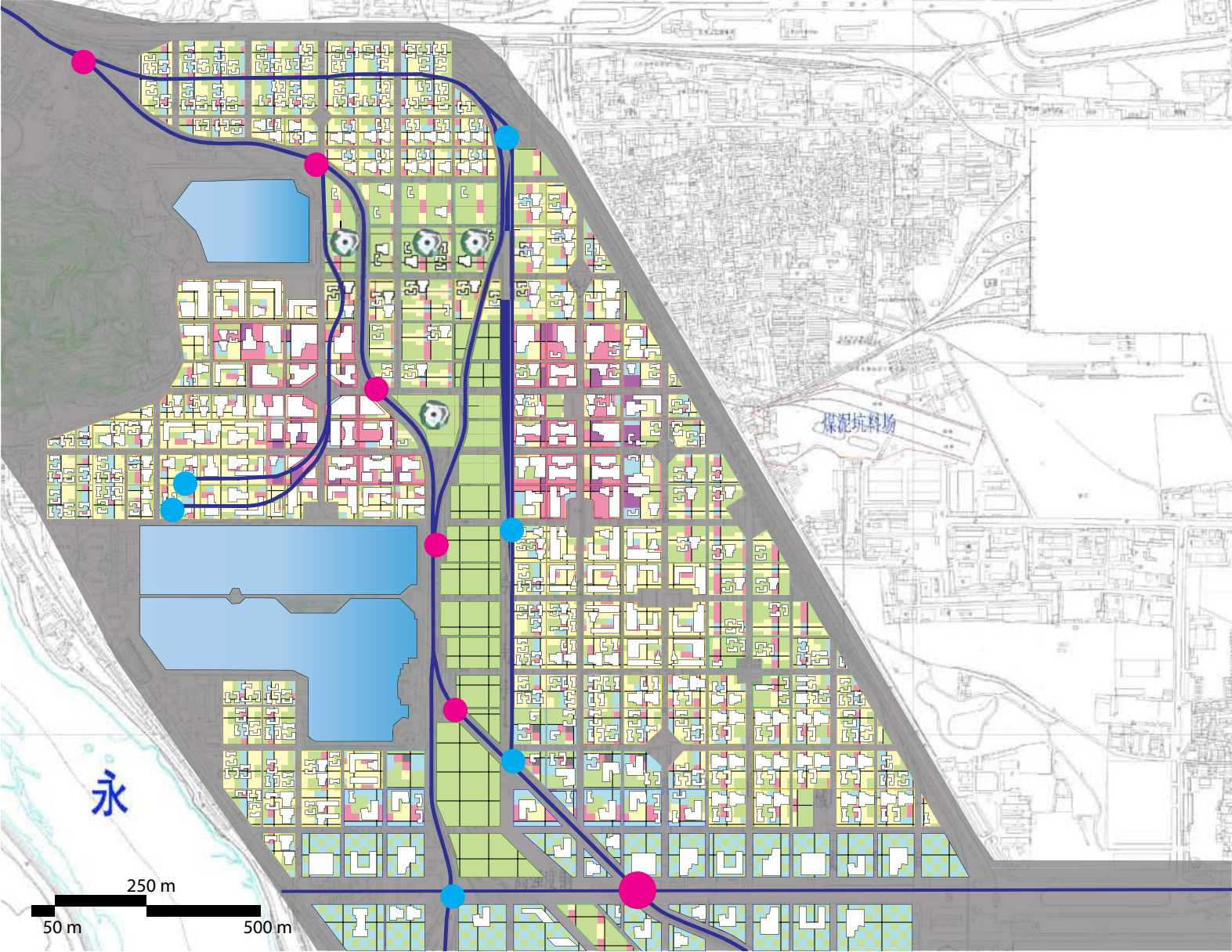

long narrow strip

keith case - zhang ruoxi - ma xiaoying - kristina katic - marissa grace desmond

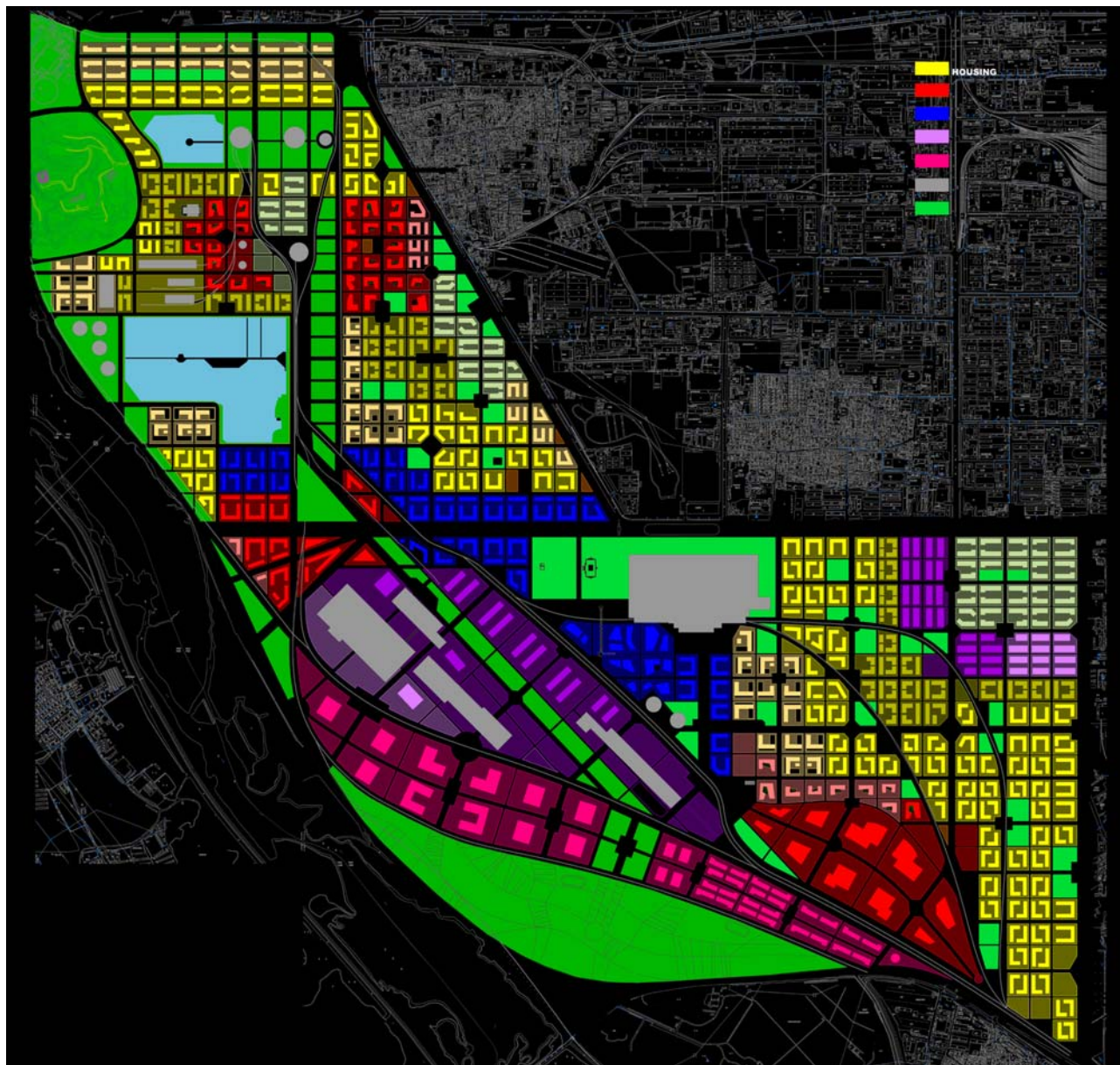

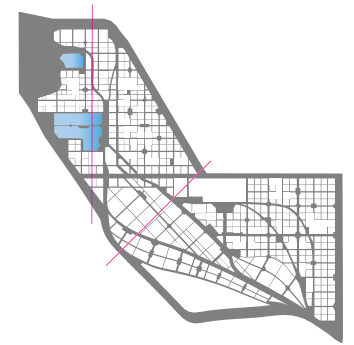
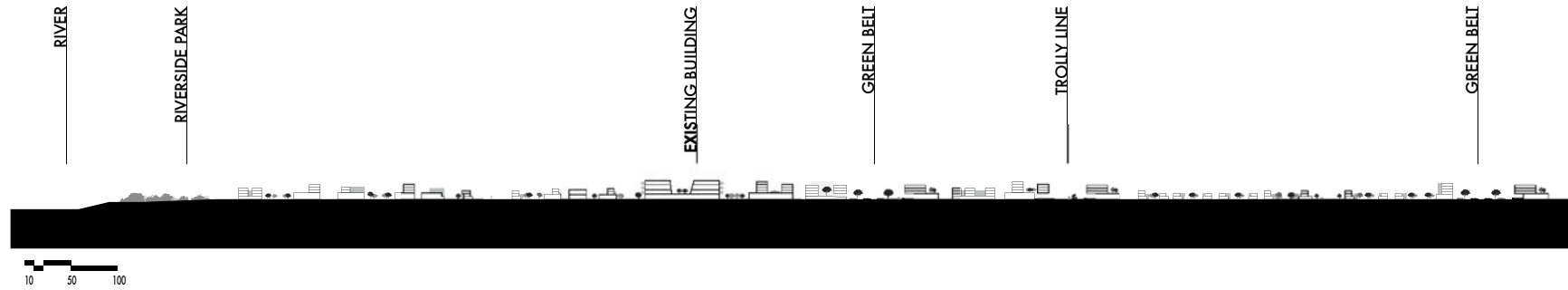
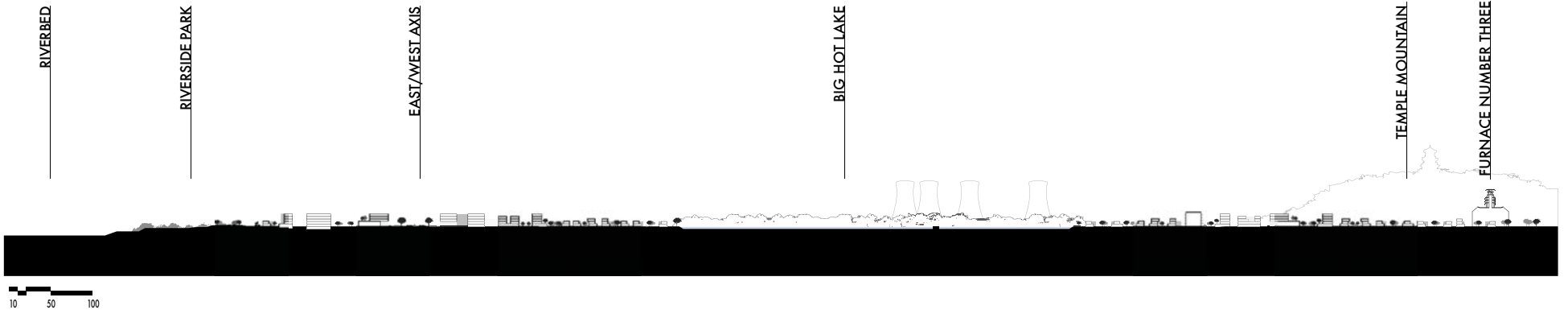

Mixed Use

The success of a mixed use block depends on the logical integration of varied programs at the architectural scale. While not every combination may result in a new architectural prototype, understanding the way that two distinct programs will interact is crucial to plan a system of growth based on flexible modules whose function is constantly changing.

Live	Garden apartments, apartment buildings, dorms			
Study	Dorm with civic and institutional skirt	Single Academic buildings, labs and workshops		
Work	Migrant worker and industria combination buildings	Industrial education workshops	Large and small-scale industrial buildings	
Buy	Shop owner apartments	Public academic buildings with associated commercial	Industrial/Commercial buildings and combination factory and store	Single commercial buildings
	Live	Study	Work	

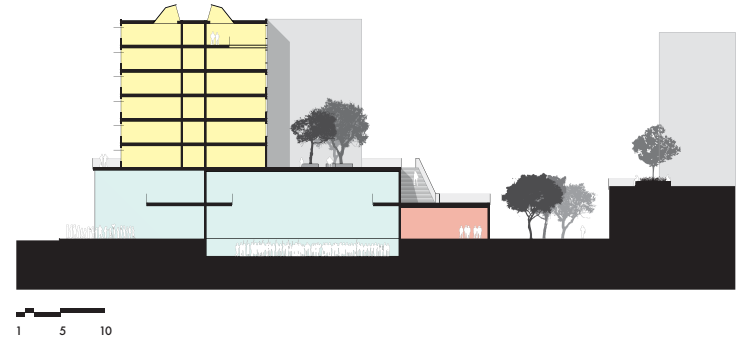

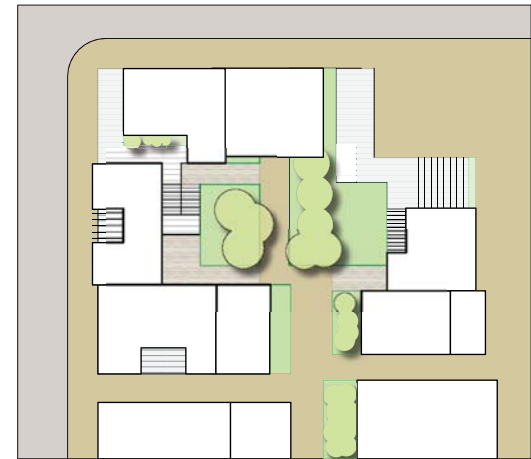
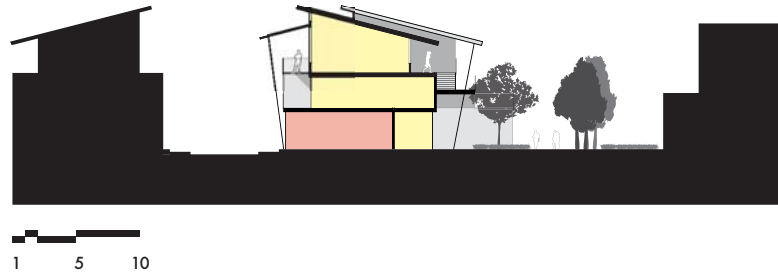

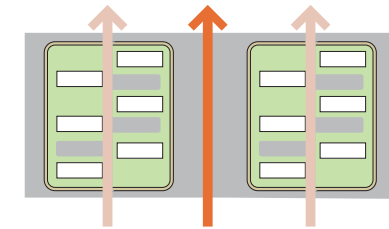

Beijing Currently in Beijing, and around the Shougang site, the city has developed according to the tower in the park pattern, where there is little hierarchy in terms of road width or treatment between circulation within and between developments. Generally and programmatic uses are not mixed and the space between the towers is reserved for parking and limited recreation.

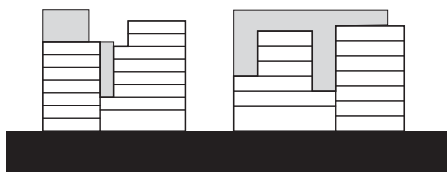
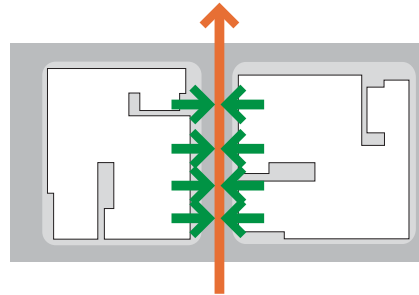

New York The hierarchy between roads and alleys is extreme in New York City. There is little public access through or into the block, rather major and minor circulation are organized by the surrounding streets. Commercial fronts the surrounding streets exclusively or develops upward within the building. Programs are striated and stacked through the building, but not mixed.

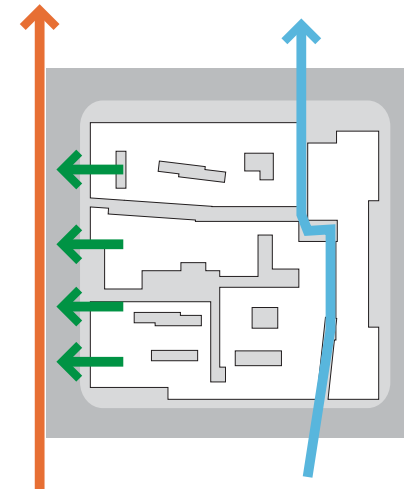

Hutongs In the hutongs there is a clear hierarchy between public and semi-public circulation. Commercial fronts the surrounding streets, which are busier and more direct. Individual houses are accessed from serpentine lanes that create spaces for semi-private functions.

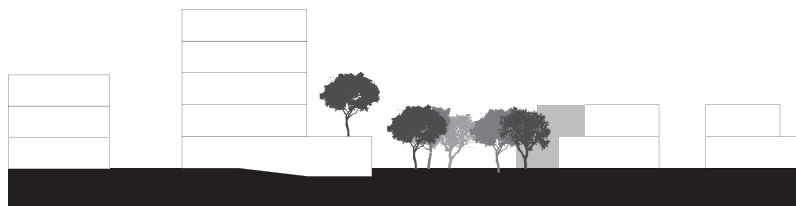
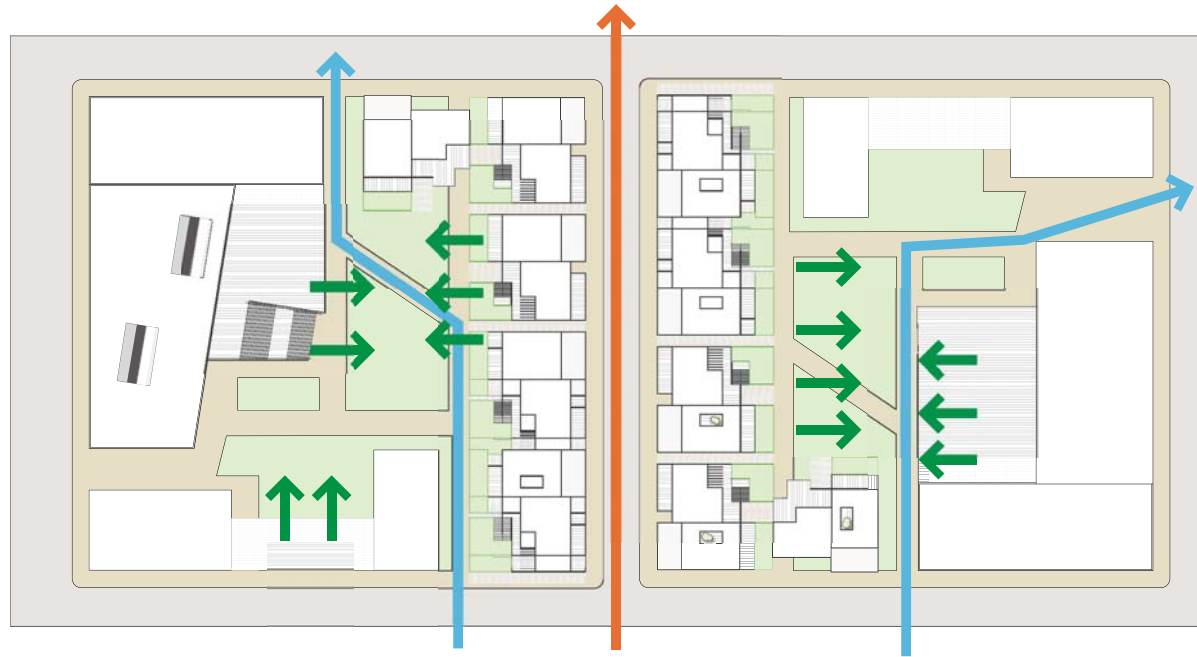

Shougang

The intention of this project was to develop a new typology of block that combines elements from contemporary urban models as well as more traditional, human-scaled precedents. In order to create flexible modules that could adapt to any combination of mixed uses within the block, the main circulation is directed through the center of the block, serving as access, greenspace and buffer between the program elements. The surrounding streets are linear and direct to facilitate bicycle and small vehicle traffic, but are narrower and more closely resemble alleys. An architecture that steps down towards the center of the block and crenellates provides more surface area for commercial frontage as well as the opportunity for semi-private spaces in front of residences.

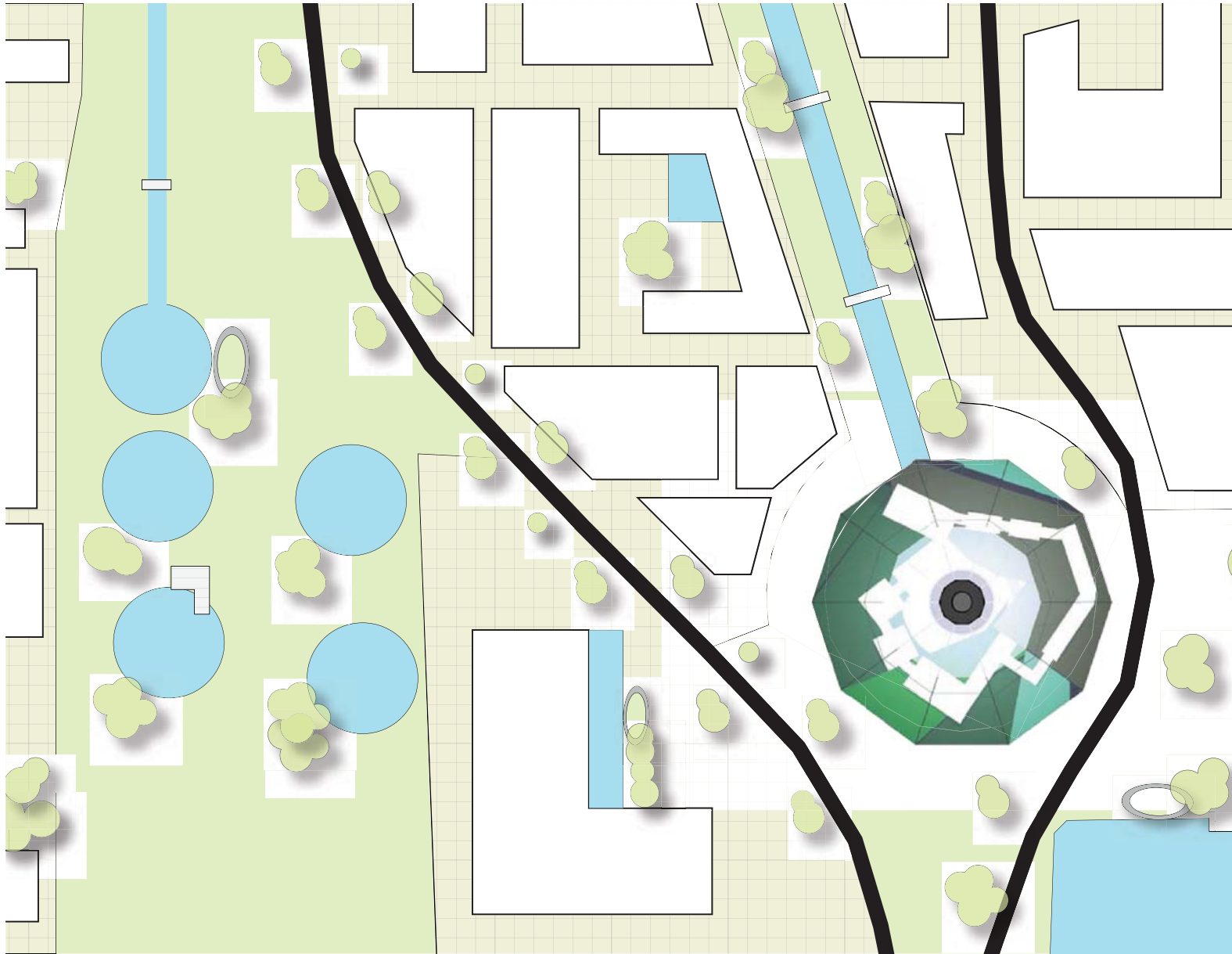

furnace # 4 as a living machine - section

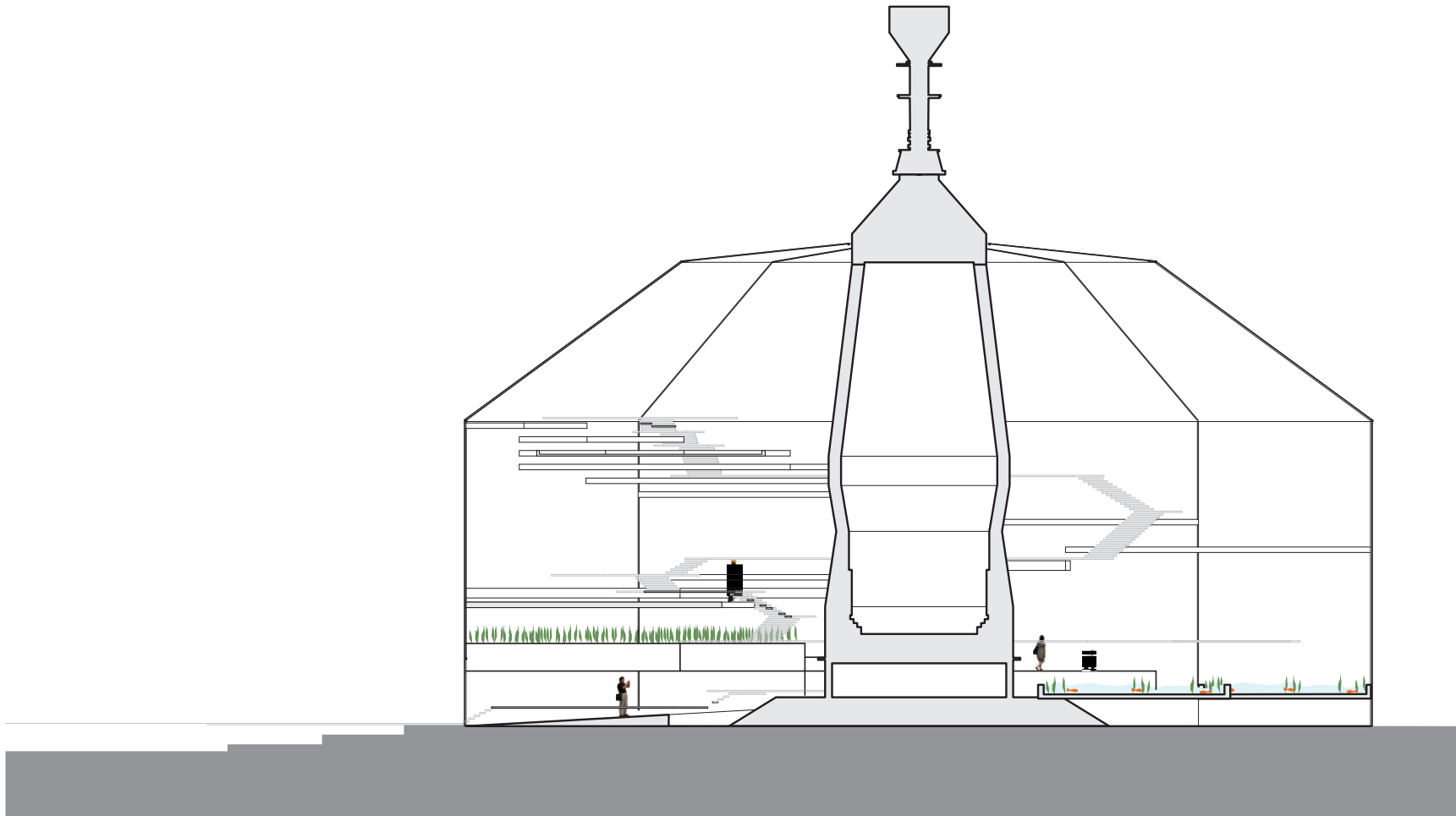

long narrow strip

keith case - zhang ruoxi - ma xiaoying - kristina katic - marissa grace desmond



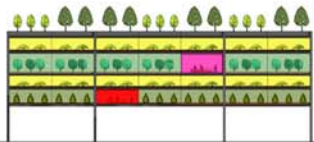
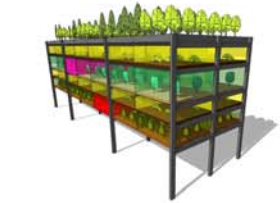

Environmental Industry
Building Styles Developed with FLEXIBLE MODULE Logic



Mix-Use Housing

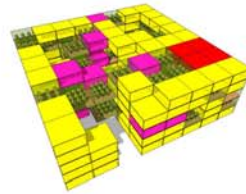

Housing



Renovated Housing with Reserved Structure

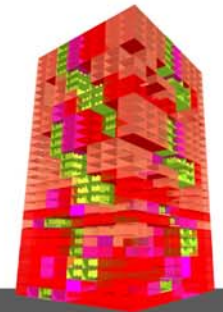

Business Tower





